

# LOUVER octagonal

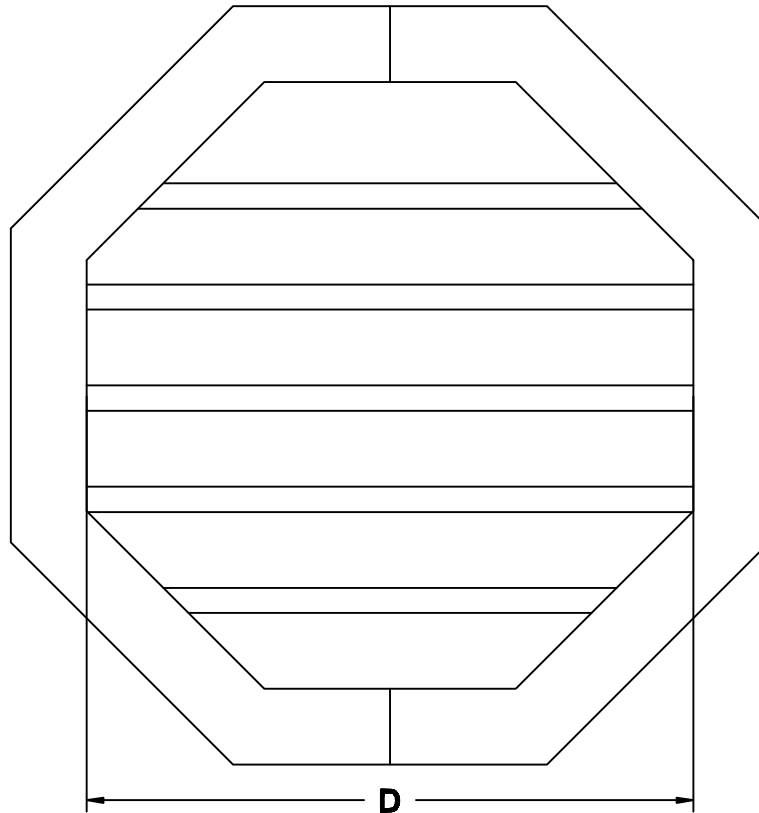

DIMENSIONS AVAILABLE:	DIA	FREE AREA:
	12"	32.8 SQ. IN.
	18"	81.6 SQ. IN.
	24"	151.1 SQ. IN.
	36"	351.9 SQ. IN.
	48"	634.5 SQ. IN.

## AVAILABLE MATERIALS:

COPPER      ZINC/ TIN COATED COPPER      PREWEATHERED ZINC      PATINA COPPER  
 PREFINISHED ALUMINUM      PAINT GRIP STEEL

WEIGHT:                                      VARIES

INSTALLATION:                              USE IN VERTICAL APPLICATION ONLY. LOUVER IS SOLDERED  
 WATERTIGHT AROUND FLANGE. OPENING SHOULD BE 1/2"  
 LARGER THAN LOUVER ALL AROUND.

OTHER INFORMATION:                      ABOVE DIMENSIONS DO NOT INCLUDE 1-1/2" FLANGE.

OTHER:    INCLUDES INSECT SCREEN OF COMPATIBLE MATERIAL.